



CANYON VILLAGE

18801-18899 N. Thompson Peak Parkway
Scottsdale, Arizona

SPECIFICATIONS - FOR LEASE

PROJECT DESCRIPTION:	Mixed-use development consisting of four buildings
TOTAL PROJECT SIZE:	±100,000 SF of office, retail and restaurant space
AVAILABLE SPEC SUITES:	\$21.50 Per Rentable Square Foot, Full Service Gross
	Building C, Suite 200: ± 1,766 RSF*
	Building C, Suite 202: ± 977 RSF*
	Building C, Suite 210: ± 2,249 RSF
	Building C, Suite 225: ± 1,497 RSF
	*Contiguous to ±2,743 SF
AVAILABLE SHELL SPACE:	\$25.00 Per Rentable Square Foot, Full Service Gross
	Building A: ± 3,213 RSF
	Building D, 2nd Floor: ± 8,281 RSF, Divisible
	Building D, 3rd Floor: ± 8,316 RSF, Divisible
EXPENSES:	Base year, expense stop
TENANT IMPROVEMENTS:	Negotiable
PARKING:	4.00/1,000 SF
YEAR BUILT:	2008
*BUILDING B:	Medical Space—Contact Plaza Companies for More Information

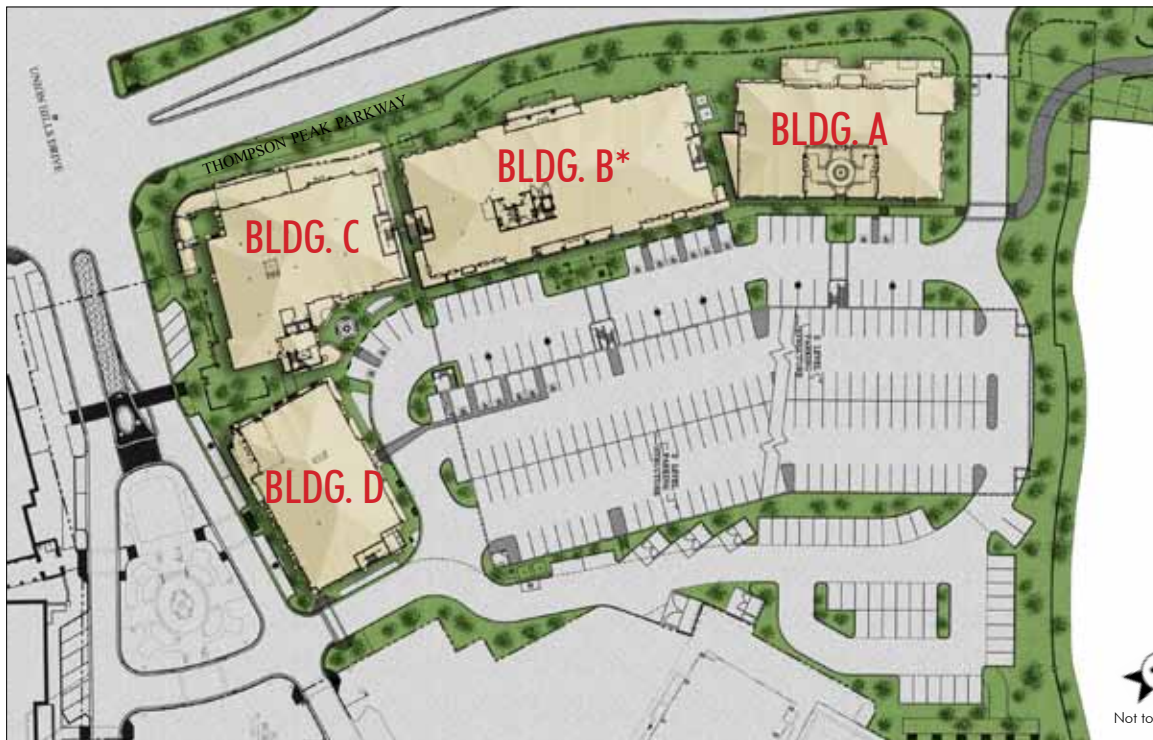

MIKE STRITTMATTER
Sales Assistant
602.735.5512
mike.strittmatter@cbre.com

BRAD ANDERSON
Executive Vice President
602.735.1713
brad.anderson@cbre.com

BRYAN TAUTE
Senior Vice President
602.735.1710
bryan.taute@cbre.com

2415 E. Camelback Rd. | Phoenix, Arizona 85016
T 602.735.5555 | F 602.735.5655
www.cbre.com/phoenix

