

2341 West Royal Palm Road

West Royal Palm Road & 24th Avenue, Just East of Interstate 17 | Phoenix, Arizona



FOR SALE OR LEASE

MIKE STRITTMATTER
Sales Assistant
602.735.5512
mike.strittmatter@cbre.com

BRAD ANDERSON
Executive Vice President
602.735.1713
brad.anderson@cbre.com

BRYAN TAUTE
Senior Vice President
602.735.1710
bryan.taute@cbre.com

CBRE

2415 East Camelback Road | Phoenix, Arizona 85016
T 602.735.5555 | F 602.735.5655 | www.cbre.com/phoenix

2341 West Royal Palm Road | Phoenix, Arizona

Building Features

- Single-Tenant Freestanding Opportunity
- ±24,568 RSF For Sale or Lease
- Freestanding Building
- 3.50:1,000 SF Parking Ratio
- 22 Covered Parking Stalls
- No Load Factor
- Existing Operation Center

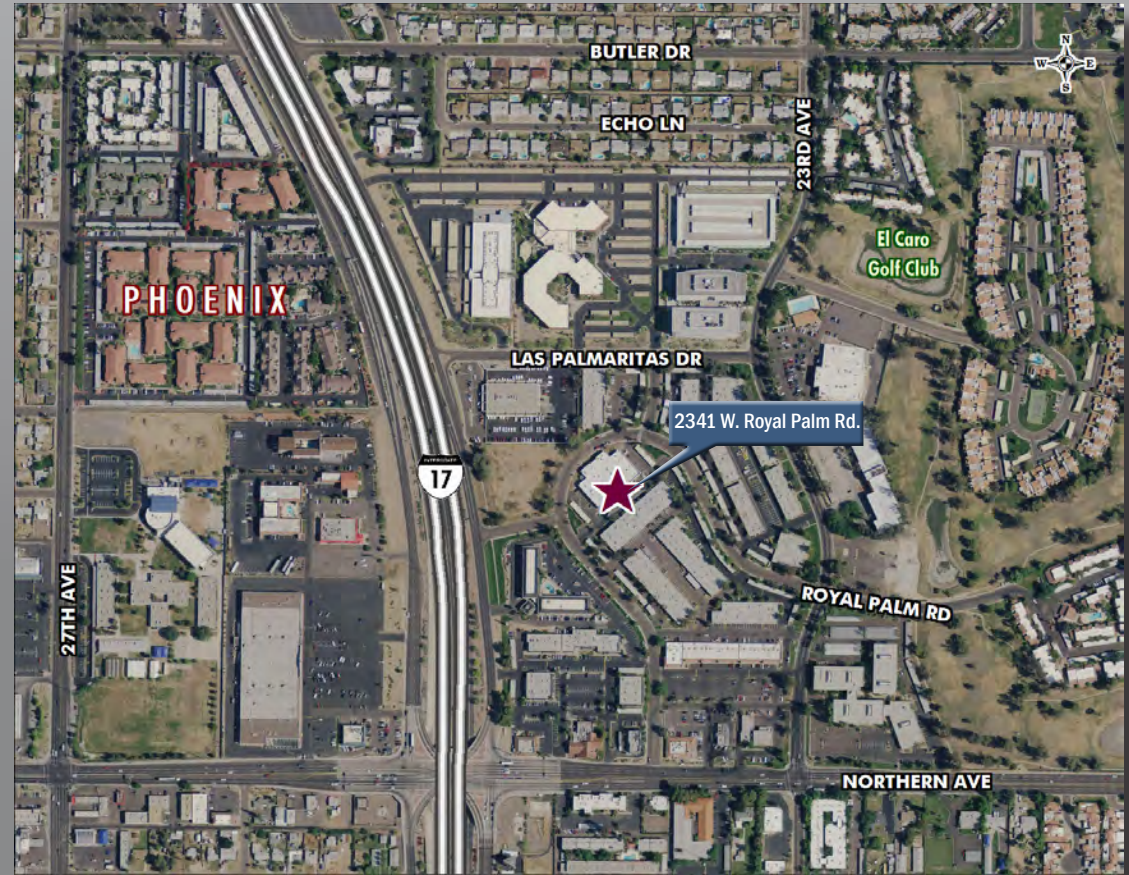

Area Highlights

- Ideal location with immediate access to Interstate 17 and Loop 101 freeways.
- Abundance of retail near Interstate 17 and Northern Avenue, including Albertsons, Walgreens, LA Fitness, Sprouts, banks, restaurants and other retail.
- Project is located in an established market.
- Central access to a large, diverse labor base within the Metrocenter office market area.